

26th March 2021

Dear Residents and Councillors,

PLANNED ROAD CLOSURES AND TEMPORARY OPENING OF CHERWELL ROAD LINK

I am writing to notify you of essential road works within the new West Durrington development to the Bellflower Corner tabletop which will cause disruption to the residents during this time. The works involve raising ironworks and block paving. The works are programmed from Monday 19th April to Tuesday 4th May and will be done in 2 phases.

Phase 1 will commence from Monday 19th April to Wednesday 28th April and will involve the complete closure of the Bellflower Corner junction. Similarly, to the tabletop works in December 2020 this will involve the temporary opening of the Cherwell Road link to the NE corner of the development.

Residents residing in the following roads will be required to divert via Cherwell Road during this time: Water Lily Way, Bellflower Drive, Lavender Close, Crocus Chase, Geranium Road, Peony Grove, Snapdragon Lane, Lupin Spinney, Iris Close, Dahlia Close and Teasel Drive.

Note for residents in Thistle Spinney - There will be no vehicular access in and out of the car park between the 19th April to 21st April. Once the Northern part of the tabletop is complete the road barrier will be removed to allow access/ egress into this car park. If residents are required to use their vehicle between this time, they are kindly requested to move their vehicle beforehand and park elsewhere on the development.

An illustration of Phase 1 is contained in Figures 1 and 2, including the diversion routes in place during this time.

On Wednesday 28th April the Cherwell Road link will be closed and Phase 2 will commence. Phase 2 involves block paving the Southern Section of the Bellflower tabletop and is planned from Wednesday 28th April to Tuesday 4th May. During this time there will be a diversion in place to the NE of the development via Cornfield Way and Water Lily Way. This is shown in Figure 2.

In anticipation of some follow up questions please see below:

- The emergency services have been informed of these works by Tetra Tech, and in the event of an emergency the emergency services will use the Cherwell Road link.
- We have contacted Adur and Worthing council and advised them that refuse vehicles will have access to the development via Cherwell Road for general waste and recycling collections whilst Phase 2 is on-going.
- No construction vehicles will be using the Cherwell Road link.
- There will be traffic signage erected at Cherwell Road, showing the flow of traffic, prioritising 1-way traffic leaving the development.
- No vehicles from the West Durrington development are to park on Cherwell Road nor Adur Avenue, we would also request residents avoid parking on the Snapdragon Lane road where possible during Phase 1 due to increased traffic flow during this time.
- Pedestrian access will still be fully opened at the Bellflower corner junction.
- Signage will be erected to the entrance of the development notifying vehicles of the road closure reading "No access past Bellflower Drive, vehicle access via Cherwell Road" a further road sign will be erected on the Y junction stipulating no through road.

- 5mph signs will be erected to the entrance of Geranium Drive for residents gaining access to Bellflower Drive and Crocus Chase.

I assure you that the roads within the West Durrington will be reopened immediately after the works are completed and that Cherwell Road link will then revert to its emergency only use.

Please note we have consulted with the Highway Authority at West Sussex County Council and with Worthing Borough Council, both of whom are aware of this short-term arrangement.

If you have any further pressing questions, please raise these with the West Durrington Residents Association, who will raise these with the Project Management team.

Yours Faithfully,



Michael Haisell

Senior Project Manager

Tetra Tech

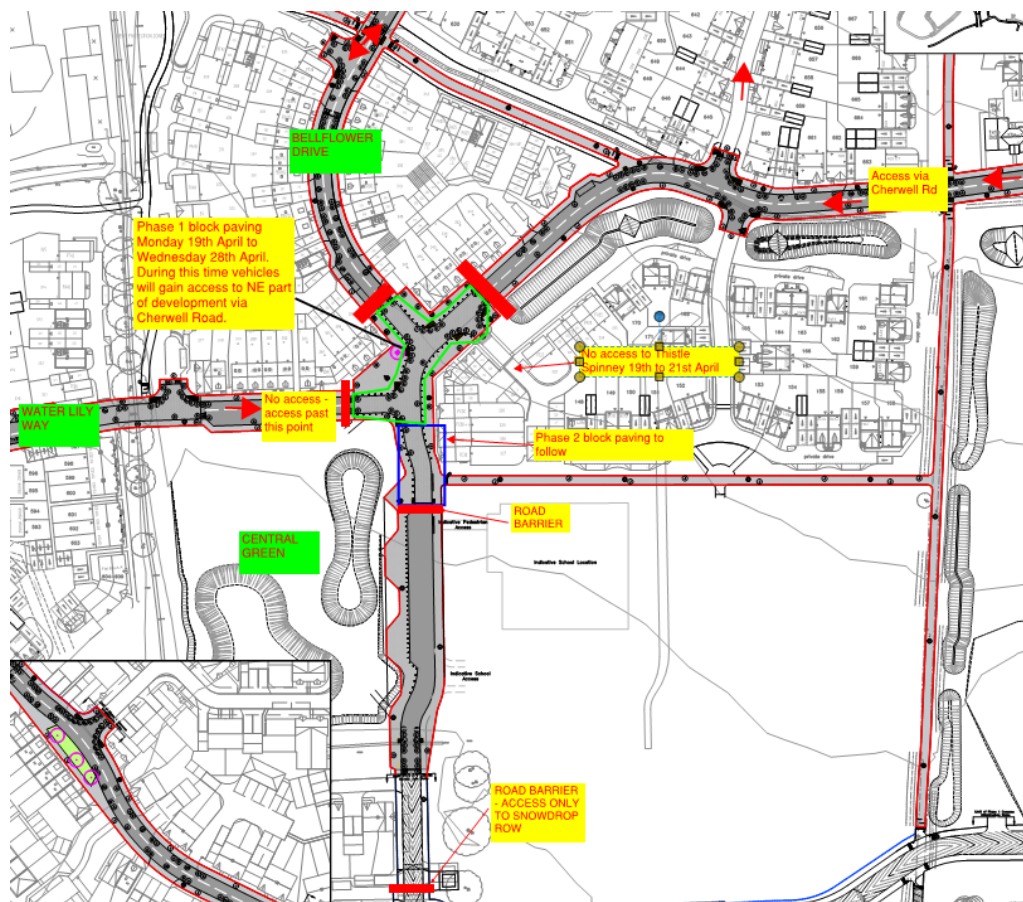

Figure 1- Phase 1 – Monday 19th April to Wednesday 28th April

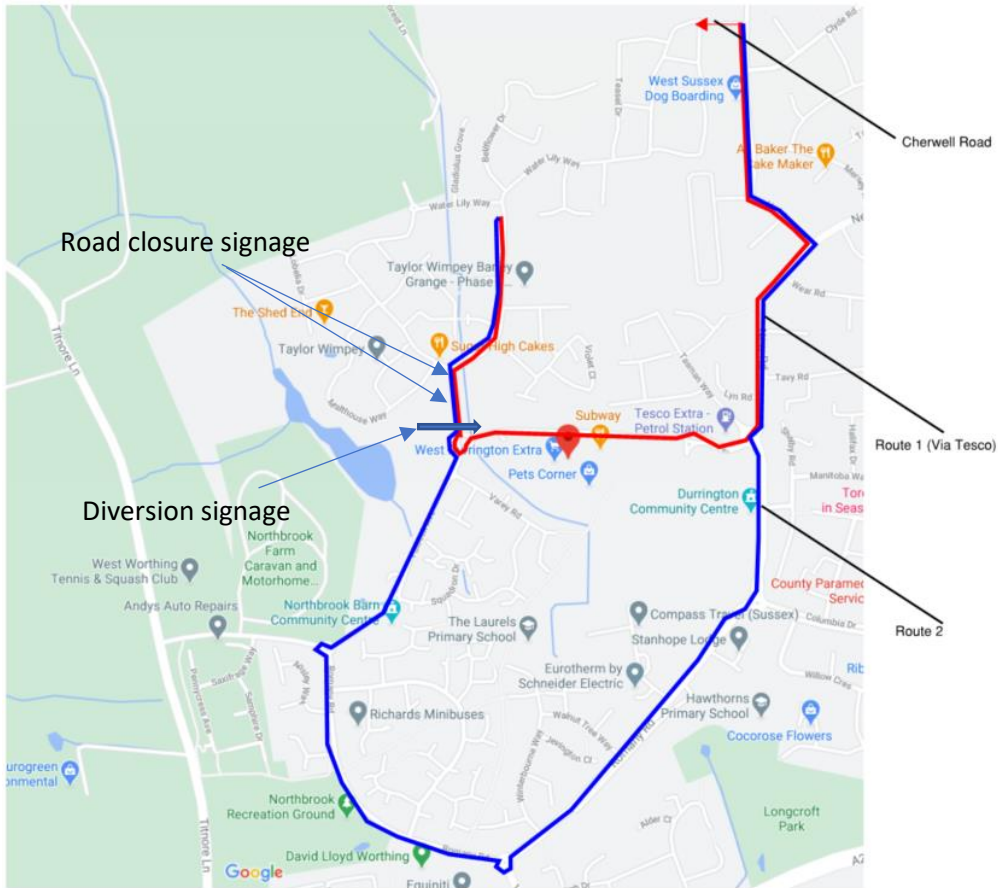

Figure 2- Phase 1 Diversion Routes

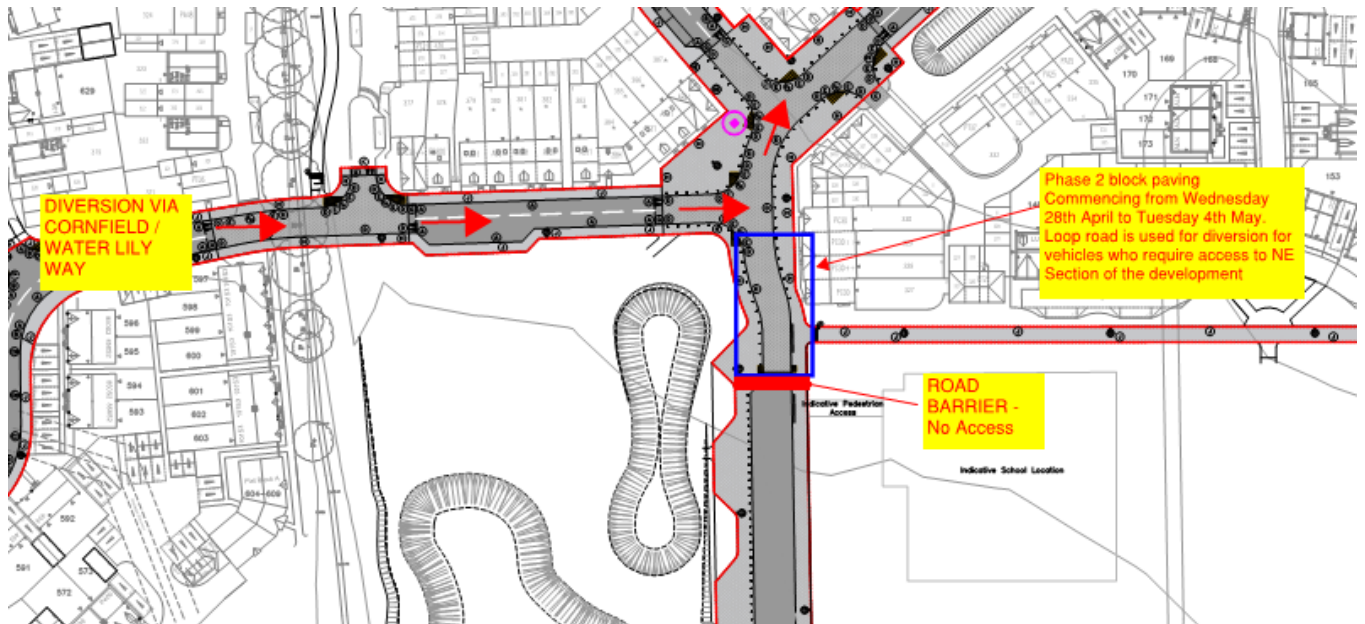

Figure 3- Phase 2 – Wednesday 28th April to Tuesday 4th May